

Cage Code: 704Q7

RevNo	Revision note	Date	Signature	Checked
-------	---------------	------	-----------	---------

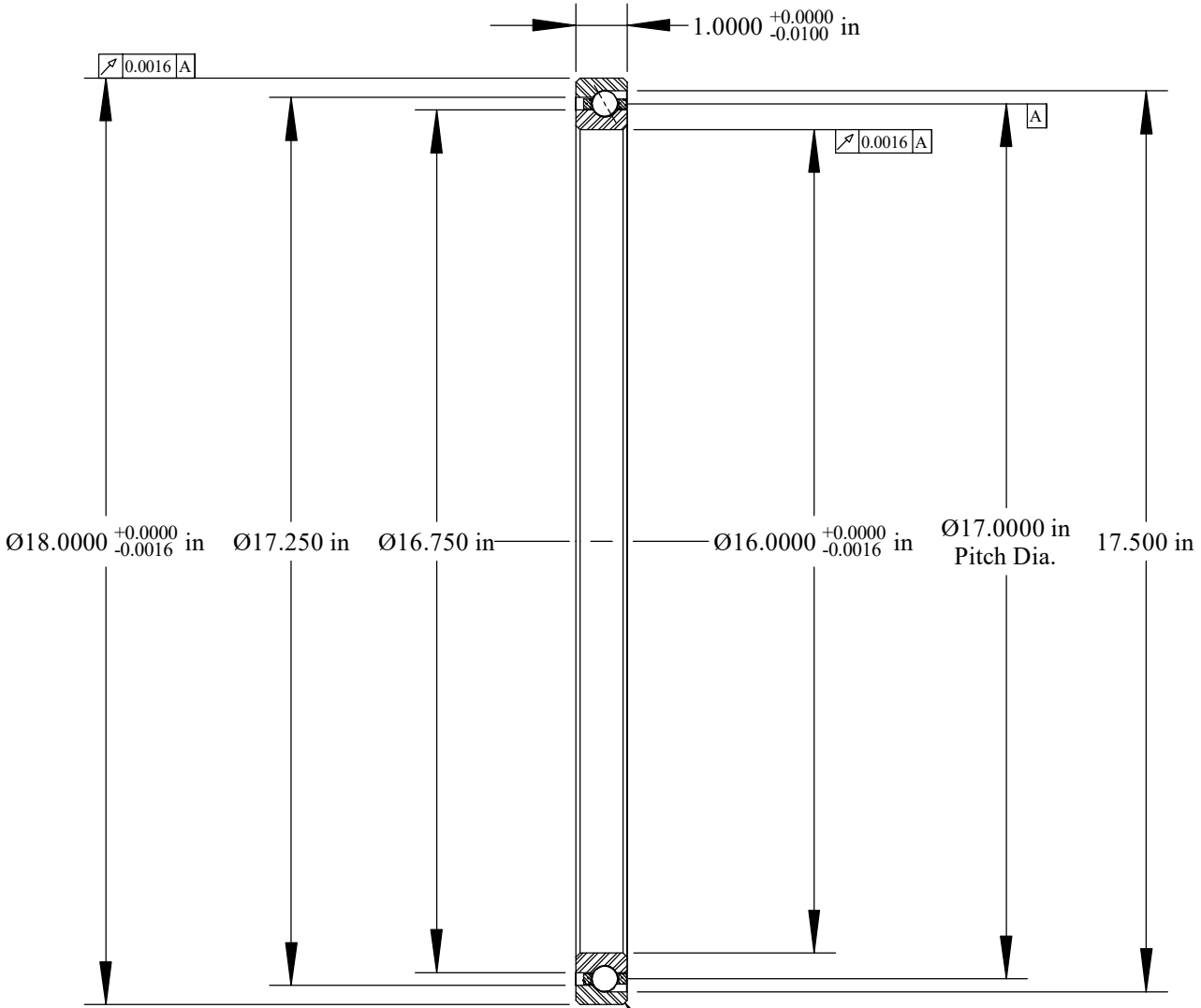

Will Clear 0.080  
Max. Fillet Radius  
4 Exterior Corners

Scale: 0.3:1

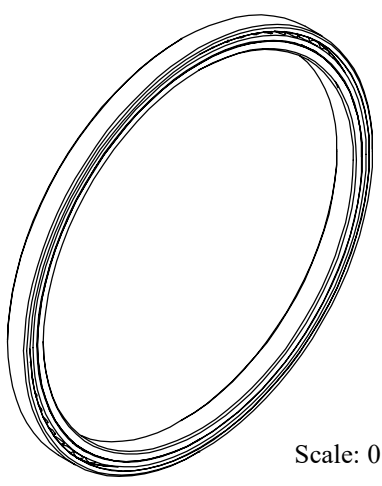

Scale: 0.15:1

	OUTER	INNER	SEPARATOR	BALL
MATERIAL	52100	52100	BRASS	52100
HARDNESS	Rc 59-62	Rc 59-62		
RACE RUN-OUT	OUTER	INNER		
ABEC RATING	PRELOAD		ROLLING ELEMENT	
1	N/A		QUANTITY	SIZE
			68	1/2
RADIAL LOAD	THRUST LOAD		MOMENT LOAD	
DYNAMIC: 12,142 Lbs. STATIC: 32,220 Lbs.	DYNAMIC: 30,830 Lbs. STATIC: 93,020 Lbs.		N/A	
RADIAL PLAY	CONTACT ANGLE		LIMITING SPEED	
N/A	30°		1100 RPM	
LUBRICATION	SEAL		BEARING WEIGHT	
LIGHT OIL PRESERVATIVE	N/A		12.40 Lbs.	

**Corporate Headquarters**  
15151 Prater Drive  
Covington, GA 30014  
(800) 431-1980  
www.ritbearing.com

UNLESS OTHERWISE SPECIFIED ALL DIMENSIONS IN INCHES

Designed by ML	Checked by ML	This drawing and the information contained herein are proprietary and the property of Ritbearing Corporation.	
<b>RG160AR0</b>		Angular Contact Thin Section Ball Bearing	
File name RG160AR0	Date December 16, 2020	REVISION A	Sheet 1 of 1